

## REPLACEMENT

1. REMOVE INSTRUMENT PANEL SUB-ASSY LOWER (See page 71-10)
2. REMOVE CLUTCH PEDAL SPRING (W/O TURN OVER)

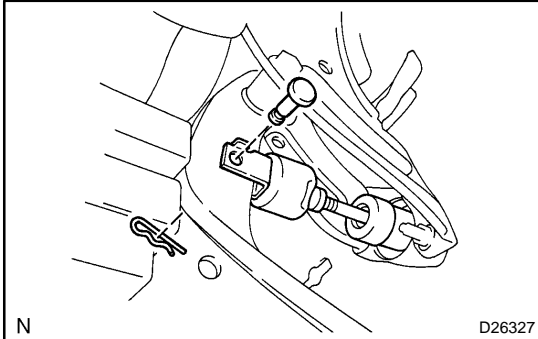

3. REMOVE CLUTCH MASTER CYLINDER PUSH ROD CLEVIS W/HOLE PIN
  - (a) Remove the clip and hole pin.

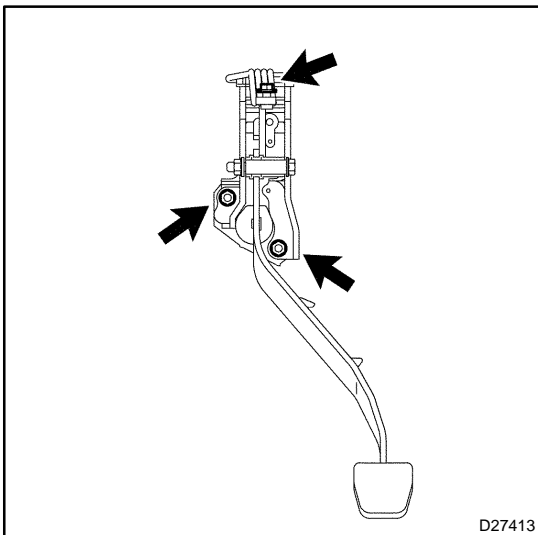

4. REMOVE CLUTCH PEDAL SUPPORT SUB-ASSY
  - (a) w/ Cruise control:  
Disconnect the clutch switch assy connector.
  - (b) Disconnect the clutch start switch assy connector.
  - (c) Remove the 2 nuts, bolt and clutch pedal support assy.

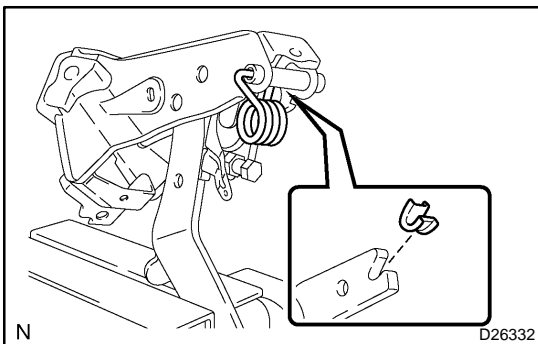

5. REMOVE TURN OVER SPRING SEAT COMPRESSION SPRING (W/ TURN OVER)
  - (a) Mount the clutch pedal in a soft jaw vise.
  - (b) Using a screwdriver, remove the spring.
6. REMOVE CLUTCH PEDAL TURNOVER BUSH (W/ TURN OVER)

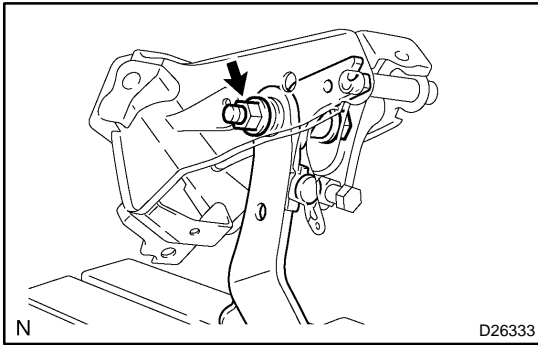
**7. REMOVE CLUTCH PEDAL SUB-ASSY**

- (a) Remove the bolt and nut.
- (b) Remove the clutch pedal sub-assy from the clutch pedal support.

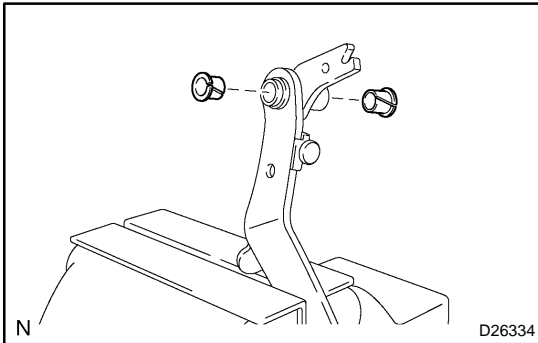
**8. REMOVE CLUTCH PEDAL PAD****9. REMOVE CLUTCH PEDAL BUSH**

- (a) Remove the 2 bushes from the clutch pedal.

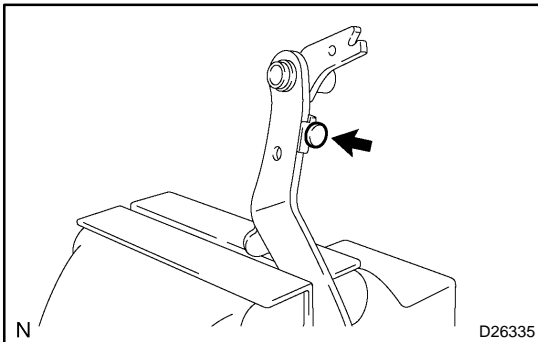
**10. REMOVE CLUTCH PEDAL NO.1 CUSHION**

- (a) Using needle-nose pliers, remove the No.1 cushion from the clutch pedal.

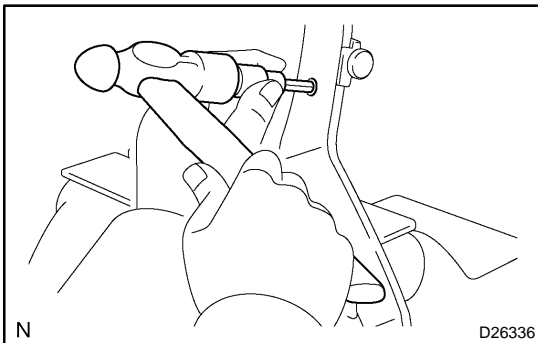
**11. REMOVE CLUTCH MASTER CYLINDER PUSH ROD CLEVIS BUSH**

- (a) Using a 8 mm hexagon wrench and a hammer, remove the clevis bush from the clutch pedal sub-assy.

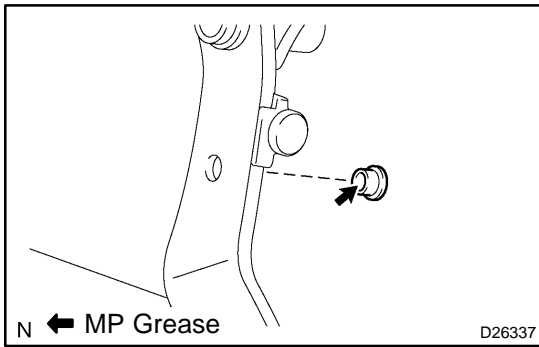

## 12. INSTALL CLUTCH MASTER CYLINDER PUSH ROD CLEVIS BUSH

- (a) Apply MP grease to inside of a new clevis bush.
- (b) Install the clevis bush to the clutch pedal.

HINT:

Install the clevis bush from the right side of the vehicle.

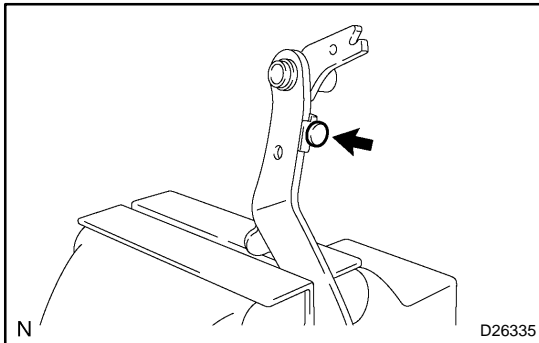

## 13. INSTALL CLUTCH PEDAL NO.1 CUSHION

- (a) Using needle-nose pliers, install the No.1 cushion to the clutch pedal.

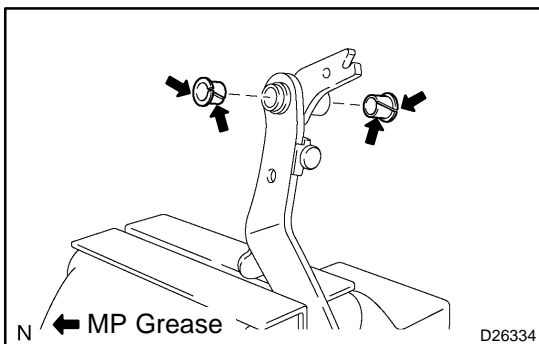

## 14. INSTALL CLUTCH PEDAL BUSH

- (a) Apply MP grease to both side of 2 new bushes.
- (b) Install the 2 bushes to the clutch pedal.

## 15. INSTALL CLUTCH PEDAL PAD

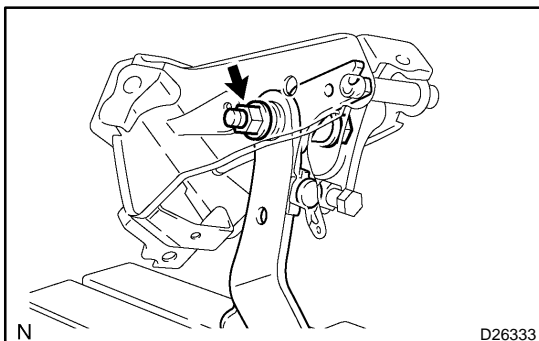

## 16. INSTALL CLUTCH PEDAL SUB-ASSY

- (a) Install the clutch pedal sub-assy to the clutch pedal support with the bolt and nut.

**Torque: 36.8 N·m (375 kgf·cm, 27 ft·lbf)**

HINT:

Install the bolt from the right side of the vehicle.

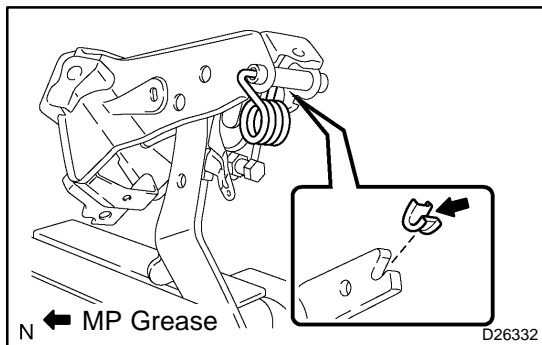

**17. INSTALL CLUTCH PEDAL TURNOVER BUSH (W/ TURN OVER)**

- (a) Apply MP grease to inside of the turn over bush.
- (b) Install the turn over bush to the clutch pedal sub-assy.

**18. INSTALL TURN OVER SPRING SEAT COMPRESSION SPRING (W/ TURN OVER)**

- (a) Apply MP grease to the contact surface of the bush and spring.
- (b) Install the spring to the clutch pedal sub-assy and clutch pedal support.

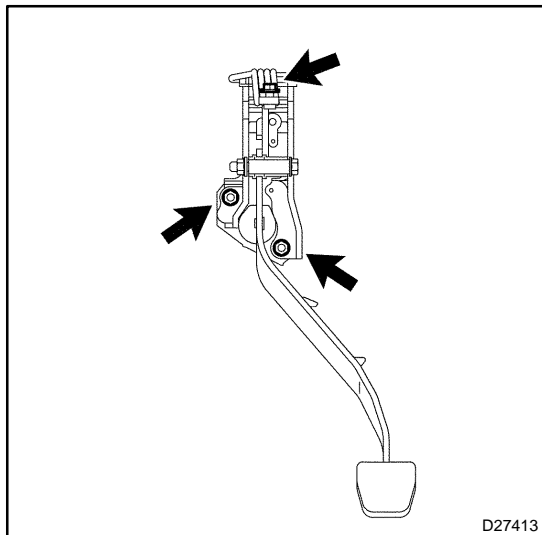

**19. INSTALL CLUTCH PEDAL SUPPORT SUB-ASSY**

- (a) Install the clutch pedal support to the vehicle with the 2 nuts and bolt.

**Torque:**

**Bolt: 19.1 N·m (195 kgf·cm, 14 ft·lbf)**

**Nut: 11.8 N·m (120 kgf·cm, 9 ft·lbf)**

- (b) Connect the clutch start switch assy connector.
- (c) w/ Cruise control:  
Connect the clutch switch assy connector.

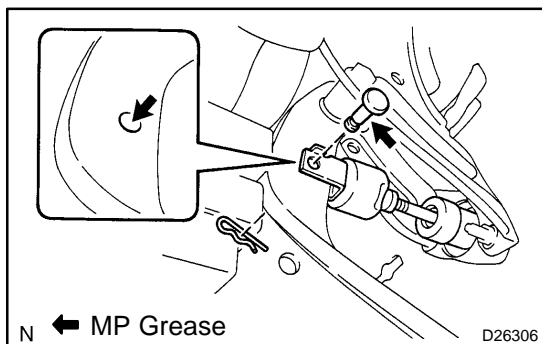

**20. INSTALL CLUTCH MASTER CYLINDER PUSH ROD CLEVIS W/HOLE PIN**

- (a) Apply MP grease to the contact surface of the hole pin and clevis bush.
- (b) Connect the clevis to the clutch pedal sub-assy with the hole pin.

**HINT:**

Install the hole pin from the right side of the vehicle.

- (c) Install the clip to the hole pin.

**21. INSTALL CLUTCH PEDAL SPRING (W/O TURN OVER)**

**22. INSTALL INSTRUMENT PANEL SUB-ASSY LOWER**

**23. INSPECT SRS WARNING LIGHT (See page 05-543)**

**24. INSPECT AND ADJUST CLUTCH PEDAL SUB-ASSY (See page 42-2)**