

OVERHAUL

HINT:

Overhaul the RH side by the same procedures as LH side.

1. **REMOVE REAR WHEEL**
2. **DISCONNECT REAR DISC BRAKE CALIPER ASSY LH (See page 32-49)**
3. **REMOVE REAR DISC (See page 32-49)**

HINT:

If the disc cannot be removed easily, turn the shoe adjuster until the wheel turns freely.

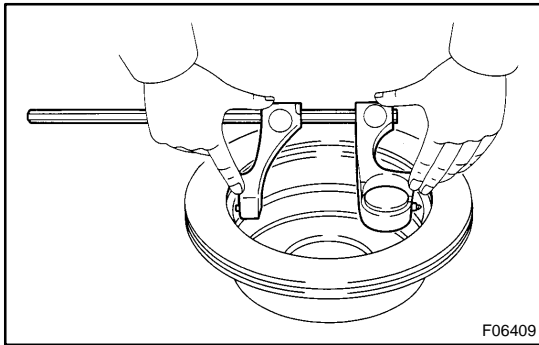

4. INSPECT BRAKE DISC INSIDE DIAMETER

- (a) Using a brake drum gauge or equivalent, measure the inside diameter of the disc.

Standard inside diameter: 173 mm (6.81 in.)

Maximum inside diameter: 174 mm (6.85 in.)

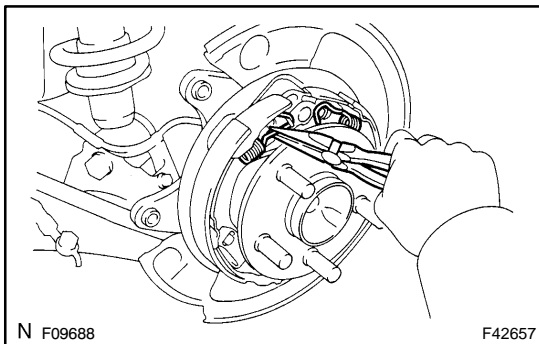

5. REMOVE PARKING BRAKE SHOE STRUT LH

- (a) Using a needle-nose pliers, remove the 2 upper side tension springs.
- (b) Remove the parking brake shoe strut LH.

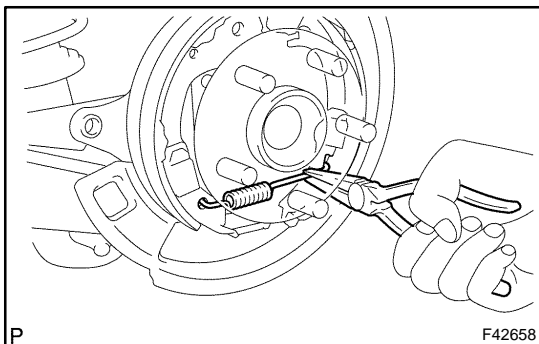

6. REMOVE PARKING BRAKE SHOE ADJUSTING SCREW SET

- (a) Using a needle-nose pliers, remove the anchor side tension spring.
- (b) Remove the shoe adjusting screw set.

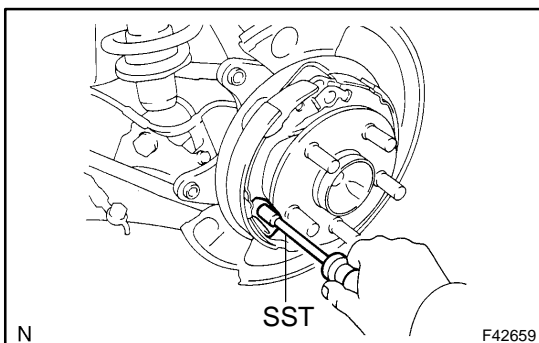

7. REMOVE PARKING BRAKE SHOE ASSY LH NO.1

- (a) Using SST, remove the parking brake shoe hold-down compression spring, parking brake shoe hold-down spring pin and parking brake shoe assy LH No.1.

SST 09718-00010

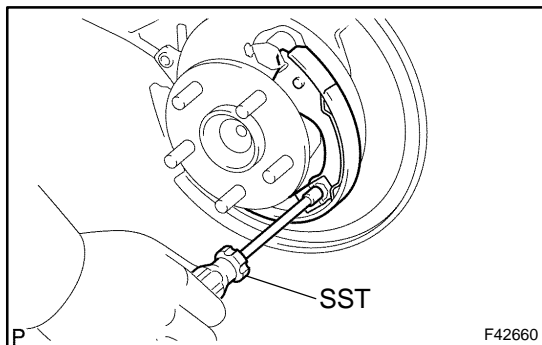

8. REMOVE PARKING BRAKE SHOE ASSY LH NO.2

- (a) Using SST, remove the parking brake shoe hold-down compression spring and parking brake shoe hold-down spring pin.

SST 09718-00010

- (b) Disconnect the parking brake shoe assy LH No.2 from the parking brake shoe lever LH, and remove the parking brake shoe LH No.2.

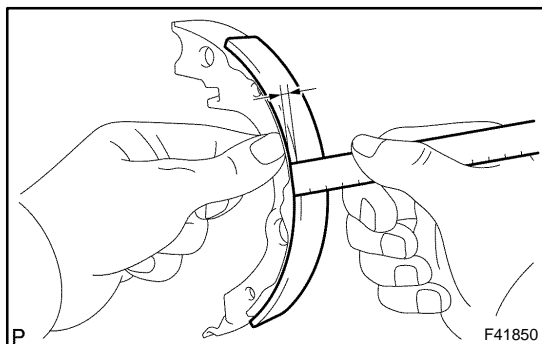

9. INSPECT PARKING BRAKE SHOE LINING THICKNESS

- (a) Using a ruler, measure the thickness of the shoe lining.

Standard thickness: 3.5 mm (0.138 in.)

Minimum thickness: 1.0 mm (0.039 in.)

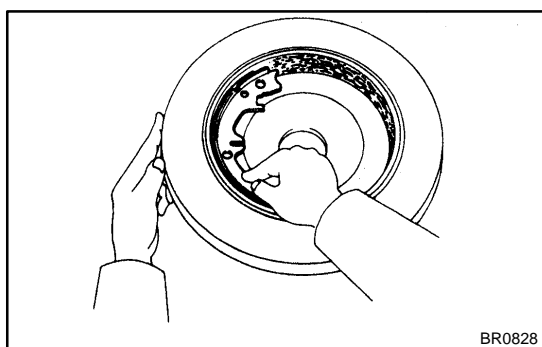

10. INSPECT BRAKE DISC AND PARKING BRAKE SHOE LINING FOR PROPER CONTACT

- (a) Apply chalk to the inside surface of the disc, then grind down the brake shoe lining to fit.

If the contact between the brake disc and the shoe lining is improper, correct it using a brake shoe grinder or replace the brake shoe assembly.

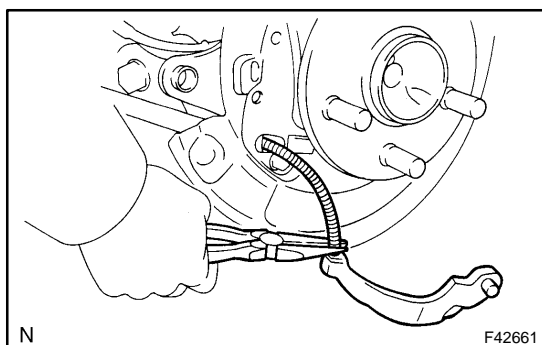

11. REMOVE PARKING BRAKE SHOE LEVER LH

- (a) Using a needle-nose pliers, disconnect the parking brake cable assy No.3 and remove the parking brake shoe lever LH.

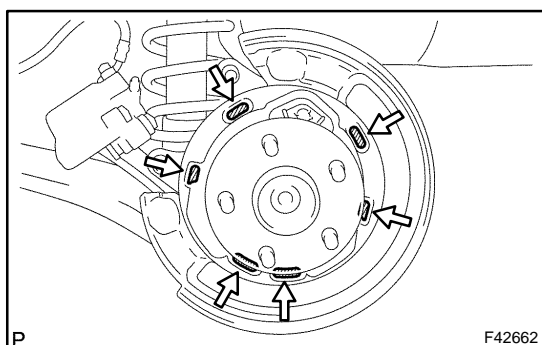

12. APPLY HIGH TEMPERATURE GREASE

- (a) Apply the high temperature grease to the shoe attached surface of backing plate.

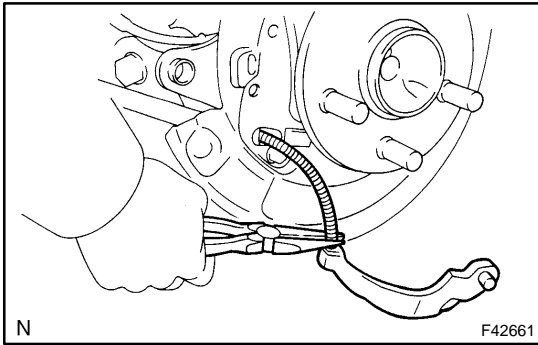
**13. INSTALL PARKING BRAKE SHOE LEVER LH**

- (a) Using a needle-nose pliers, connect the parking brake cable assy No.3 to the parking brake shoe lever LH.

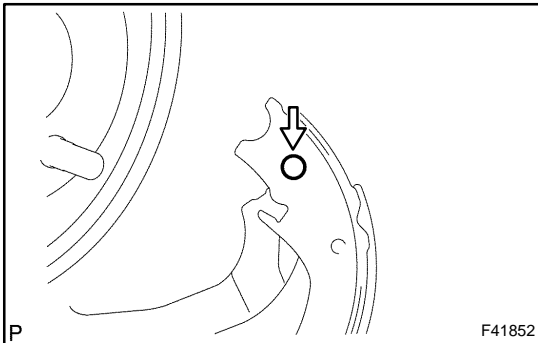
**14. INSTALL PARKING BRAKE SHOE ASSY LH NO.2**

- (a) Apply the high temperature grease to the contact part of the parking brake shoe and parking brake shoe lever.

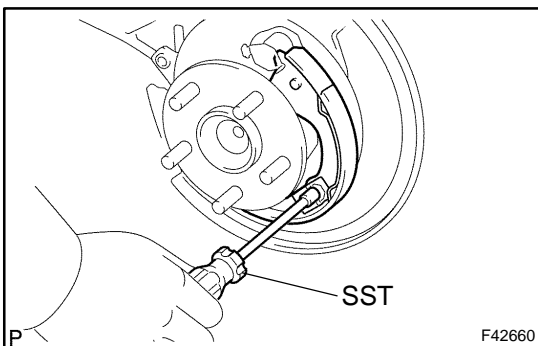

- (b) Using SST, install the parking brake shoe LH No.2 with the parking brake shoe hold-down compression spring and parking brake shoe hold-down spring pin.
SST 09718-00010

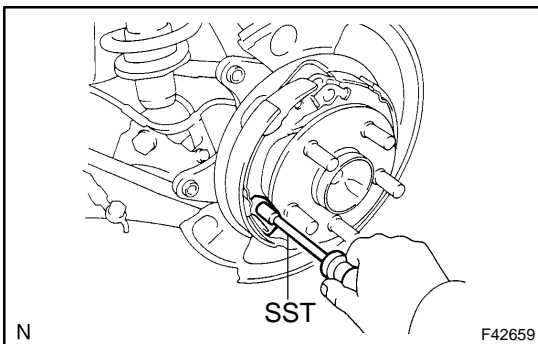
**15. INSTALL PARKING BRAKE SHOE ASSY LH NO.1**

- (a) Using SST, install the parking brake shoe LH No.1 with the parking brake shoe hold-down compression spring and parking brake shoe hold-down spring pin.
SST 09718-00010

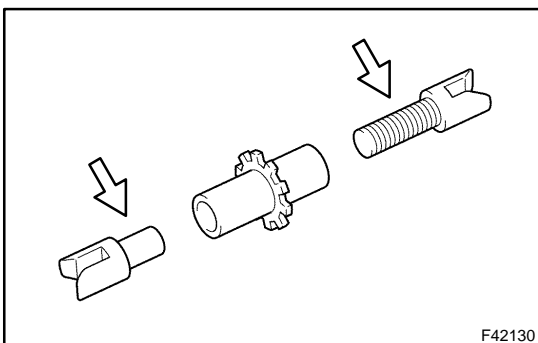
**16. INSTALL PARKING BRAKE SHOE ADJUSTING SCREW SET**

- (a) Apply the high temperature grease to the adjusting bolt and support piece.
(b) Install the parking brake shoe adjusting screw set LH.

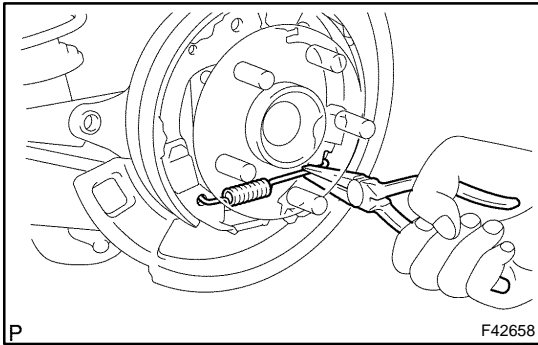
PARKING BRAKE - PARKING BRAKE ASSY (2ZZ-GE)

- (c) Using a needle-nose pliers, install the tension spring.

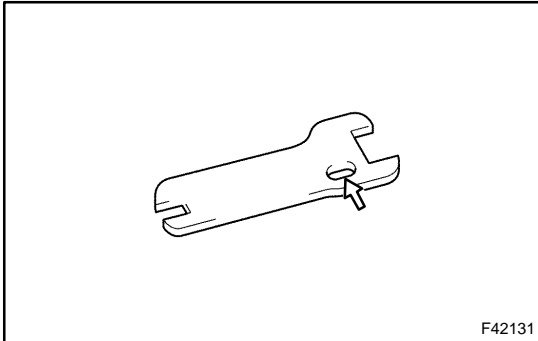
**17. INSTALL PARKING BRAKE SHOE STRUT LH**

- (a) Apply the high temperature grease to the contact part of the shoe strut and tension spring.
 (b) Install the parking brake shoe strut LH.

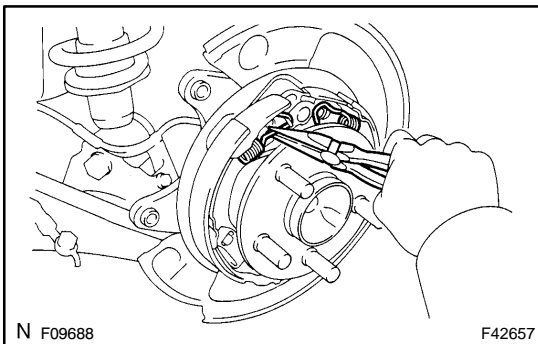

- (c) Using a needle-nose pliers, install the 2 upper side tension springs.

HINT:

Install the 2 tension spring securely to the grooves of the shoe strut.

18. CHECK PARKING BRAKE INSTALLATION

- (a) Check that each part is installed properly.

NOTICE:

There should be no oil or grease on the friction surface of the shoe lining and disc.

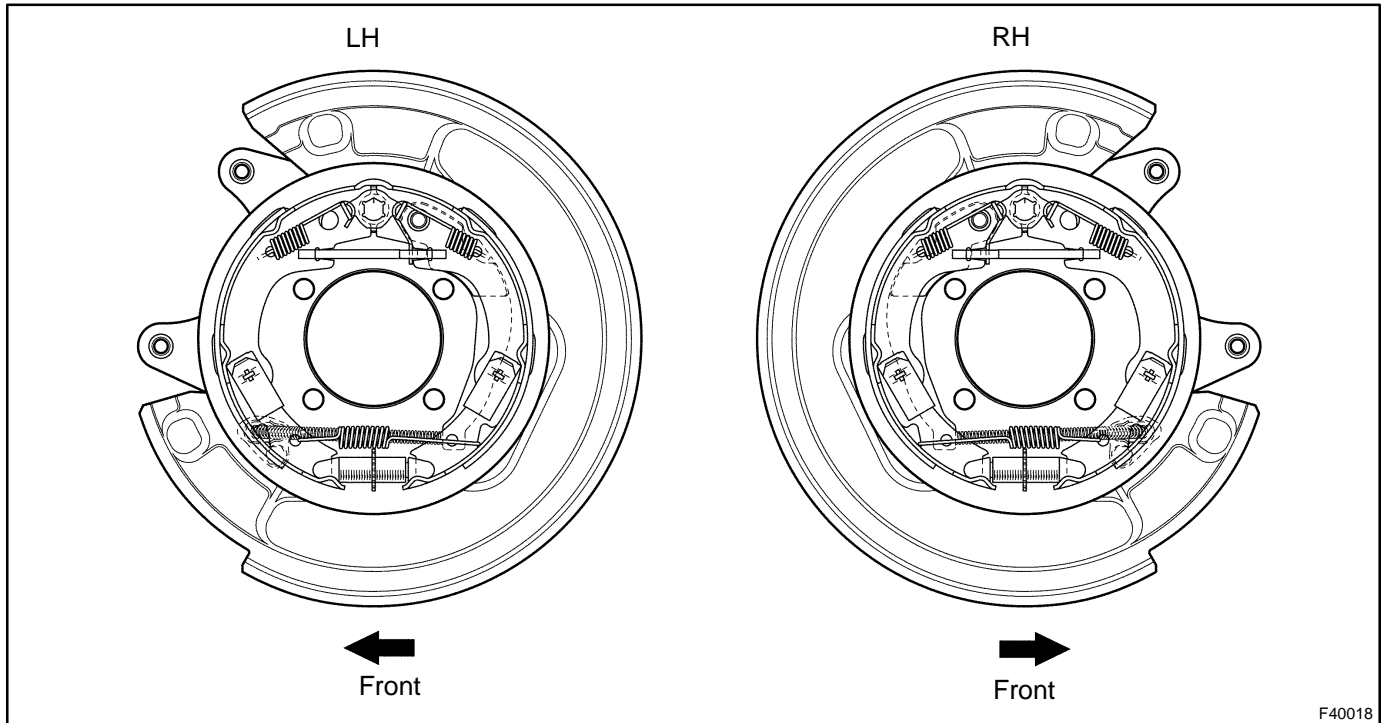

F40018

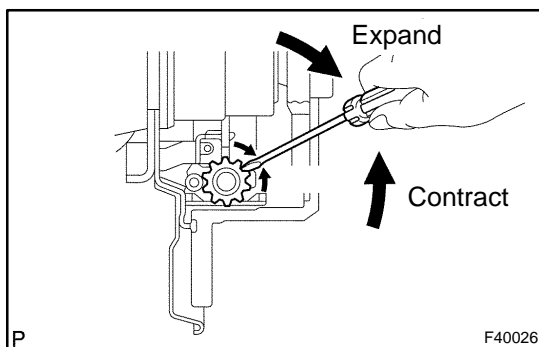
19. INSTALL REAR DISC (See page 32-49)

P

F40026

20. ADJUST PARKING BRAKE SHOE CLEARANCE

- Temporarily install the hub nuts.
- Remove the hole plug, and turn the adjuster and expand the shoes until the disc locks.
- Contract the shoe adjuster until the disc can rotate smoothly.
Standard : Return 8 notches
- Check that there is no brake drag.
- Install the hole plug.

21. CONNECT REAR DISC BRAKE CALIPER ASSY LH (See page 32-49)**22. INSTALL REAR WHEEL**

Torque: 103 N·m (1,050 kgf·cm, 76 ft·lbf)

23. INSPECT PARKING BRAKE LEVER TRAVEL (See page 33-2)**24. ADJUST PARKING BRAKE LEVER TRAVEL (See page 33-2)**