

# STABILIZER BAR REAR (4WD)

## REPLACEMENT

27087-01

HINT:

COMPONENTS: See page 27-2.

1. REMOVE REAR WHEEL
2. REMOVE EXHAUST PIPE (See page 15-4)
3. REMOVE PROPELLER W/CENTER BEARING SHAFT ASSY (See page 30-6)  
SST 09325-20010

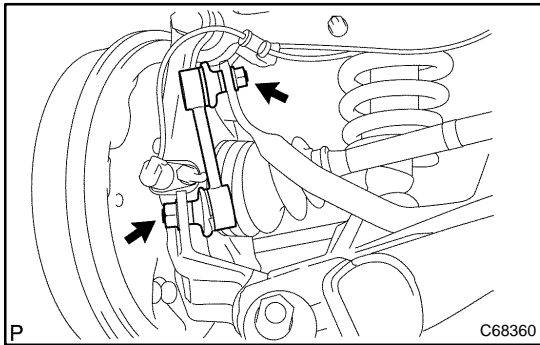

### 4. REMOVE REAR STABILIZER LINK ASSY LH

- (a) Remove the 2 nuts and rear stabilizer link assy LH.

HINT:

If ball joint turns together with the nut, use a hexagon (5 mm) wrench to hold the stud.

### 5. REMOVE REAR STABILIZER LINK ASSY RH

HINT:

Remove the RH side by the same procedures as the LH side.

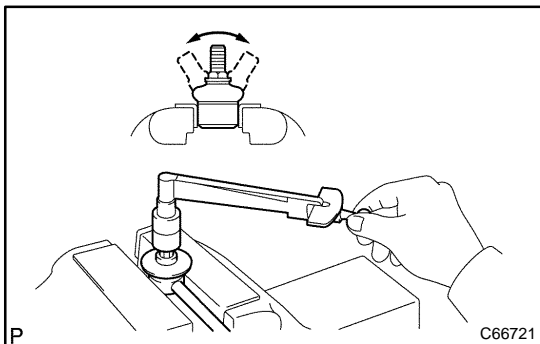

### 6. INSPECT REAR STABILIZER LINK ASSY LH

- (a) As shown in the illustration, flip the ball joint stud back and forth 5 times, before installing the nut.
- (b) Using a torque wrench, turn the nut continuously at a rate of 2 – 4 seconds per 1 turn and take the torque reading on the 5th turn.

**Turning torque:**

**0.05 – 1.0 N·m (0.5 – 10 kgf·cm, 0.4 – 8.7 in.·lbf)**

**NOTICE:**

- Neither abnormal drag nor rattle exists during the rotation.
- Neither crack nor grease leakage exists on the dust cover.

### 7. REMOVE REAR AXLE SHAFT LH NUT (See page 30-66)

SST 09930-00010

### 8. REMOVE REAR AXLE SHAFT RH NUT

SST 09930-00010

HINT:

Remove the RH side by the same procedures as the LH side.

### 9. REMOVE REAR BRAKE DRUM SUB-ASSY

HINT:

Use the same manner described above to the other side.

### 10. DISCONNECT SPEED SENSOR REAR LH (W/ ABS) (See page 27-32)

**11. DISCONNECT SPEED SENSOR REAR RH (W/ ABS)**

HINT:

Disconnect the RH side by the same procedures as the LH side.

**12. REMOVE FRONT BRAKE SHOE (See page 32-41)**

SST 09718-00010

HINT:

Use the same manner described above to the other side.

**13. REMOVE PARKING BRAKE SHOE STRUT SET LH (See page 32-41)**

SST 09703-30010

**14. REMOVE PARKING BRAKE SHOE STRUT SET RH**

SST 09703-30010

HINT:

Remove the RH side by the same procedures as the LH side.

**15. REMOVE REAR BRAKE SHOE (See page 32-41)**

SST 09718-00010

HINT:

Use the same manner described above to the other side.

**16. DISCONNECT PARKING BRAKE CABLE ASSY NO.3 (See page 27-27)****17. DISCONNECT PARKING BRAKE CABLE ASSY NO.2**

HINT:

Disconnect the RH side by the same procedures as the LH side.

**18. DISCONNECT REAR BRAKE TUBE NO.4 (See page 30-66)**

SST 09023-00100

**19. DISCONNECT REAR BRAKE TUBE NO.3**

SST 09023-00100

HINT:

Disconnect the RH side by the same procedures as the LH side.

**20. SEPARATE REAR SUSPENSION ARM ASSY NO.1 LH (See page 30-66)****21. SEPARATE REAR SUSPENSION ARM ASSY NO.1 RH**

HINT:

Separate the RH side by the same procedures as the LH side.

**22. SEPARATE UPPER CONTROL ARM ASSY (See page 27-32)**

HINT:

Separate the RH side by the same procedures as the LH side.

**23. REMOVE REAR AXLE ASSY LH (See page 30-66)****24. REMOVE REAR AXLE ASSY RH**

HINT:

Remove the RH side by the same procedures as the LH side.

**25. REMOVE REAR SUSPENSION ARM ASSY NO.1 LH (See page 27-27)****26. REMOVE REAR SUSPENSION ARM ASSY NO.1 RH**

HINT:

Remove the RH side by the same procedures as the LH side.

**27. REMOVE REAR SUSPENSION MEMBER SUB-ASSY (See page 27-32)**

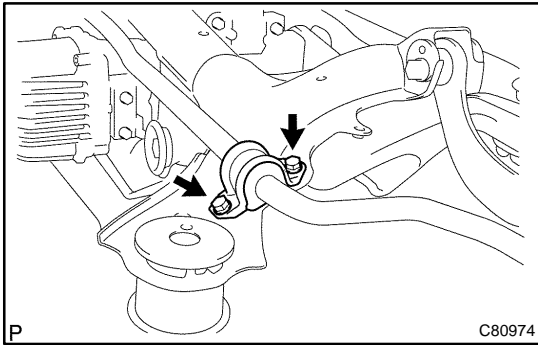
**28. REMOVE STABILIZER BAR REAR**

- (a) Remove the 4 bolts, 2 rear stabilizer bar bracket No.1 from the rear suspension member sub-assy.
- (b) Remove the 2 stabilizer bush rear from the stabilizer bar rear.

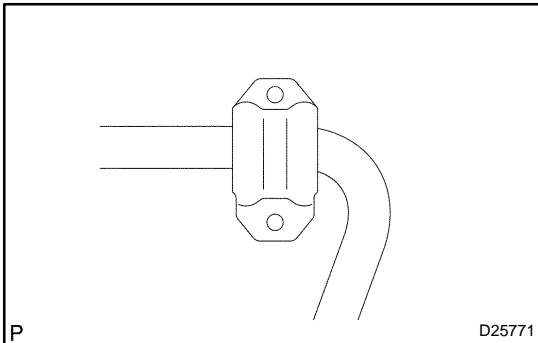
**29. INSTALL STABILIZER BAR REAR**

- (a) Install the 2 stabilizer bush rear to the stabilizer bar rear.

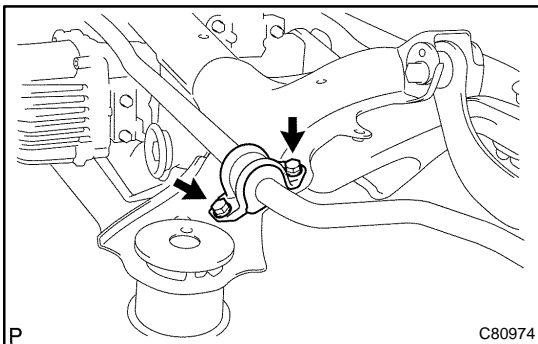

- (b) Install the stabilizer bar rear with 4 bolts.  
**Torque: 18 N·m (184 kgf·cm, 13 ft·lbf)**

**30. INSTALL REAR SUSPENSION MEMBER SUB-ASSY (See page 27-32)****31. TEMPORARY TIGHTEN UPPER CONTROL ARM ASSY (See page 27-32)**

HINT:

Temporarily tighten the RH side by the same procedures as the LH side.

**32. INSTALL REAR AXLE ASSY LH (See page 30-66)****33. INSTALL REAR AXLE ASSY RH**

HINT:

Install the RH side by the same procedures as the LH side.

**34. INSTALL REAR SUSPENSION ARM ASSY NO.1 LH (See page 27-27)****35. INSTALL REAR SUSPENSION ARM ASSY NO.1 RH**

HINT:

Install the RH side by the same procedures as the LH side.

**36. CONNECT REAR BRAKE TUBE NO.4 (See page 30-66)**

SST 09023-00100

**37. CONNECT REAR BRAKE TUBE NO.3**

HINT:

Connect the RH side by the same procedures as the LH side.

SST 09023-00100

**38. CONNECT PARKING BRAKE CABLE ASSY NO.3 (See page 27-27)****39. CONNECT PARKING BRAKE CABLE ASSY NO.2**

2003 COROLLA MATRIX (RM940U)

## HINT:

Connect the RH side by the same procedures as the LH side.

**40. APPLICATION HIGH TEMPERATURE GREASE (See page 32-41)****41. INSTALL REAR BRAKE SHOE (See page 32-41)**

SST 09718-00010

## HINT:

Use the same manner described above to the other side.

**42. INSTALL PARKING BRAKE SHOE STRUT SET LH (See page 32-41)**

SST 09703-30010

**43. INSTALL PARKING BRAKE SHOE STRUT SET RH**

SST 09703-30010

## HINT:

Install the RH side by the same procedures as the LH side.

**44. INSTALL FRONT BRAKE SHOE (See page 32-41)**

SST 09718-00010

## HINT:

Use the same manner described above to the other side.

**45. CHECK REAR DRUM BRAKE INSTALLATION (See page 32-41)****46. CONNECT SPEED SENSOR REAR LH (W/ ABS) (See page 27-32)****47. CONNECT SPEED SENSOR REAR RH (W/ ABS)**

## HINT:

Connect the RH side by the same procedures as the LH side.

**48. INSTALL REAR BRAKE DRUM SUB-ASSY****49. ADJUST REAR DRUM BRAKE SHOE CLEARANCE (See page 32-41)****50. INSTALL REAR AXLE SHAFT LH NUT (See page 30-66)****51. INSTALL REAR AXLE SHAFT RH NUT**

## HINT:

Install the RH side by the same procedures as the LH side.

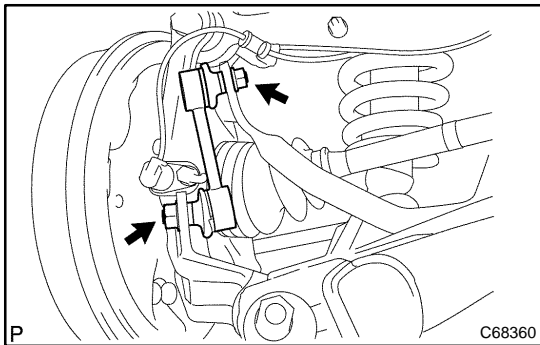
**52. INSTALL REAR STABILIZER LINK ASSY LH**

(a) Install the rear stabilizer link assy LH with 2 nuts.

**Torque: 44 N·m (449 kgf·cm, 32 ft·lbf)**

## HINT:

If ball joint turns together with the nut, use a hexagon (5 mm) wrench to hold the stud.

**53. INSTALL REAR STABILIZER LINK ASSY RH**

## HINT:

Install the RH side by the same procedures as the LH side.

**54. TEMPORARY TIGHTEN PROPELLER W/CENTER BEARING SHAFT ASSY (See page 30-6)****55. FULLY TIGHTEN PROPELLER W/CENTER BEARING SHAFT ASSY (See page 30-6)****56. INSTALL EXHAUST PIPE (See page 15-4)****57. CHECK EXHAUST GAS LEAK****58. STABILIZE SUSPENSION (See page 27-16)**

**59. FULLY TIGHTEN UPPER CONTROL ARM ASSY (See page 27-32)**

HINT:

Use the same manner described above to the other side.

**60. FULLY TIGHTEN REAR SUSPENSION ARM ASSY NO.1 LH (See page 27-27)****61. FULLY TIGHTEN REAR SUSPENSION ARM ASSY NO.1 RH**

HINT:

Fully tighten the RH side by the same procedures as the LH side.

**62. BLEED BRAKE LINE (See page 32-6)****63. INSPECT PARKING BRAKE LEVER TRAVEL (See page 33-2)****64. ADJUST PARKING BRAKE LEVER TRAVEL (See page 33-2)****65. INSPECT AND ADJUST REAR WHEEL ALIGNMENT (See page 27-7)****66. CHECK ABS SPEED SENSOR SIGNAL (W/ ABS) (See page 05-316)**